

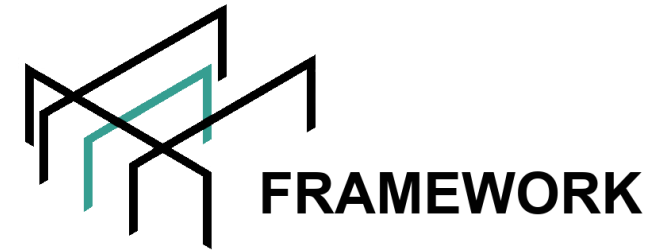
**FRAMEWORK**

**STRUCTURAL STEEL DESIGNERS**



**SPORTOWA 4A / 9 STREET  
05-600 GRÓJEC, POLAND  
NIP: 797 20 80 355**

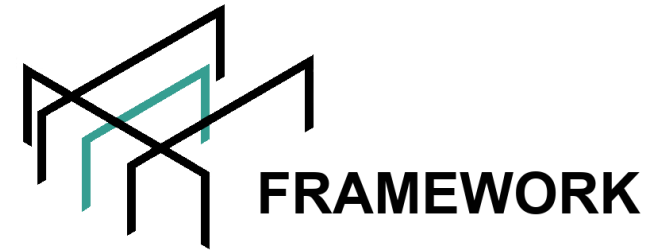
**[WWW.FRAMEWORK.COM.PL](http://WWW.FRAMEWORK.COM.PL)**



# **WE ARE DESIGNING**

## **STEEL STRUCTURES FOR THE INDUSTRY**

**AUTOMOTIVE**  
**CHEMICAL**  
**METALLURGICAL**  
**METAL**  
**ENERGETIC**  
**CEMENT-LIME**  
**ENVIRONMENTAL PROTECTION**



# THE TYPES OF STEEL STRUCTURES

- **SUPPORT STRUCTURES OF PRODUCTION LINES (TECHNOLOGICAL PLATFORMS)**
- **PIPERACKS PLATFORM**
- **STEELWORK FOR PAINT SHOP**
- **STEELWORK FOR FINAL ASSEMBLY**
- **CRANE TRACKS**
- **CONVEYORS PLATFORMS**
- **HIGH BAY STORAGE WAREHOUSE**
- **CURTAIN WALLS**
- **SUBSTRUCTURE OF MACHINES AND EQUIPMENT**
- **BUILDING ELEMENTS ADAPTED TO PRODUCTION LINES**

**WE CARRY OUT PROJECTS FOR STRUCTURES LOCATED IN SEISMIC AREAS  
(USA, CHINA, SOUTH AFRICA, MEXICO, TURKEY, UAE, EU).**



# OUR DESIGN REALIZATIONS

**CUSTOMER:** PHARMA INDUSTRY  
**LOCATION:** NIEPOŁOMICE, POLAND  
**PHASE PROJECT:** BASIC AND DETAIL DESIGN  
**MAIN MATERIAL:** STEEL GALVANIZED, COVER PLATE AND GRIDS  
**TOTAL WEIGHT:** 7 300 KG – AHU PLATFORM

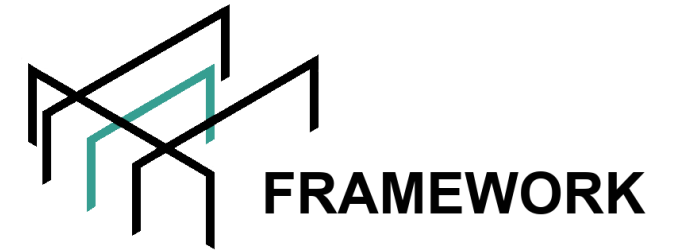
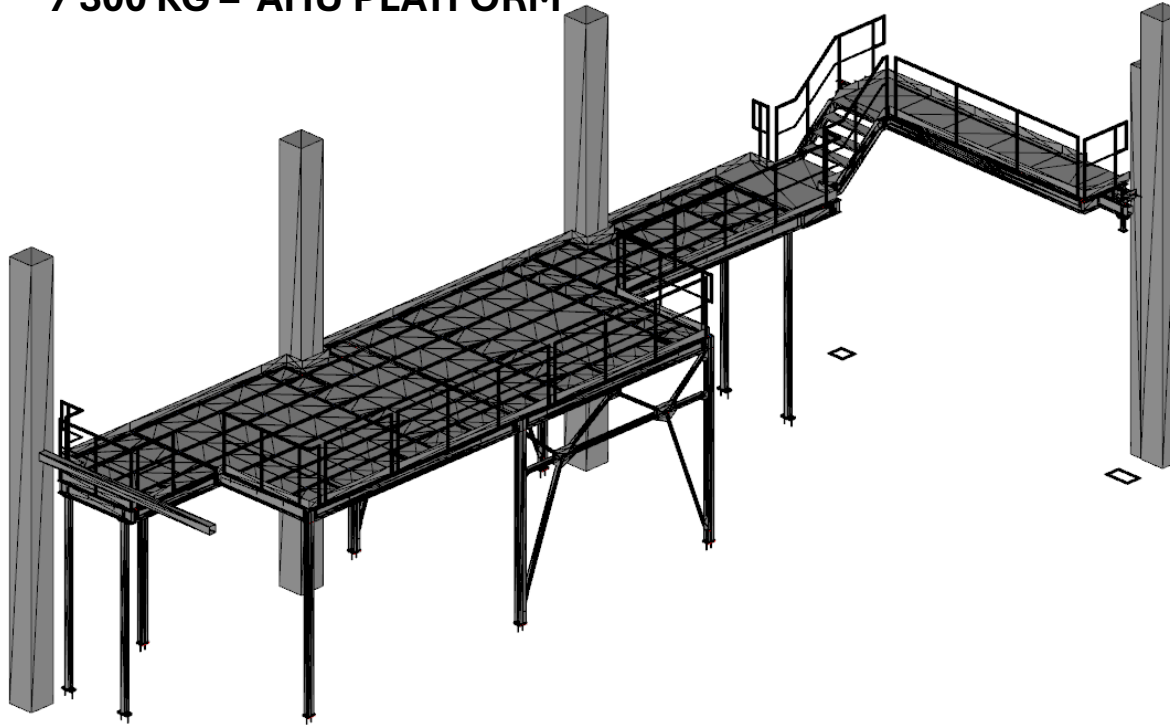
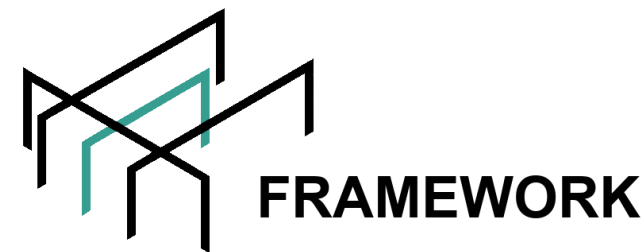


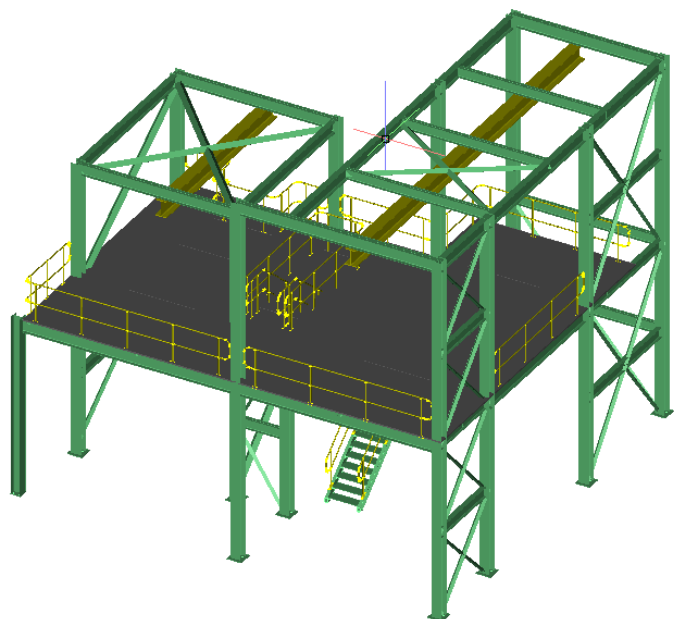
PHOTO FROM THE REALIZATION  
(ZERO MISTAKES DURING  
MANUFACTURING AND ASSEMBLY)



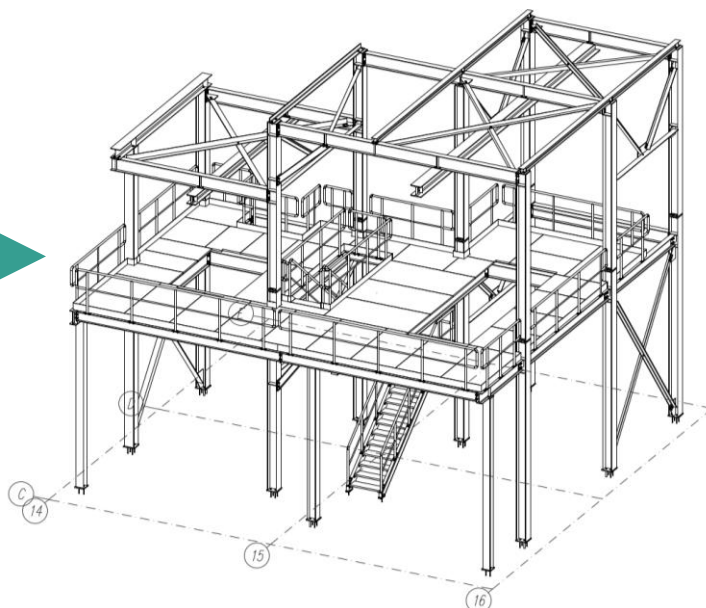
# OUR DESIGN REALIZATIONS



**CUSTOMER:** METALLURGY INDUSTRY - PGM  
**LOCATION:** ZAWIERCIE, POLAND  
**PHASE PROJECT:** BASIC AND DETAIL DESIGN  
**MAIN MATERIAL:** STEEL, COVER GRIDS BY GRP (GLASS REINFORCED PLASTIC)  
**TOTAL WEIGHT:** 23 800 KG – PLATFORM WITH TWO CRANE TRACKS



FIRST CONCEPT OF STEEL STRUCTURE FROM CLIENT  
28 500 KG BEFORE OPTIMIZATION OF STATIC MODEL



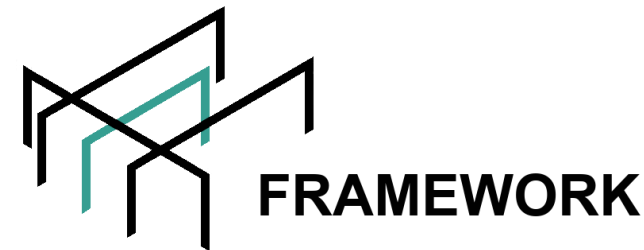
THE FINAL MODEL OF STEEL STRUCTURES  
23 800 KG AFTER THE OPTIMIZATION OF STATIC MODEL



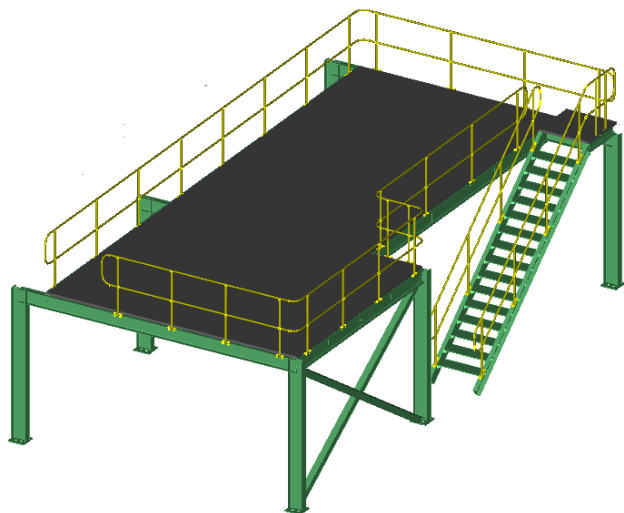
PHOTO FROM THE REALIZATION  
(ZERO MISTAKES DURING  
MANUFACTURING AND ASSEMBLY)



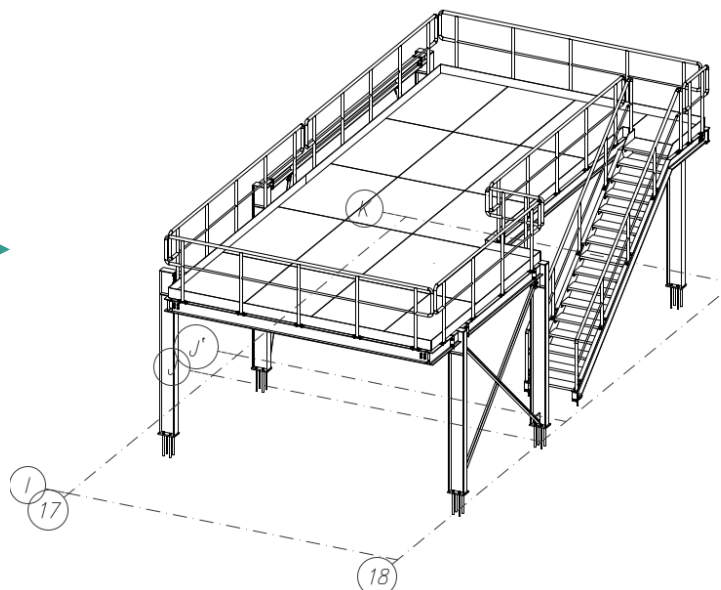
# OUR DESIGN REALIZATIONS



**CUSTOMER:** METALLURGY INDUSTRY - PGM  
**LOCATION:** ZAWIERCIE, POLAND  
**PHASE PROJECT:** BASIC AND DETAIL DESIGN  
**MAIN MATERIAL:** STEEL, COVER GRIDS BY GRP (GLASS REINFORCED PLASTIC)  
**TOTAL WEIGHT:** 5 400 KG – MAINTENANCE PLATFORM



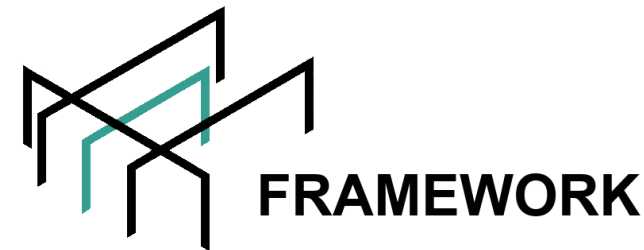
FIRST CONCEPT OF STEEL STRUCTURE FROM CLIENT  
6 160 KG TOTAL WEIGHT  
BEFORE OPTIMIZATION OF STATIC MODEL



THE FINAL MODEL OF STEEL STRUCTURES  
5 400 KG AFERT THE OPTIMIZATION STATIC MODEL

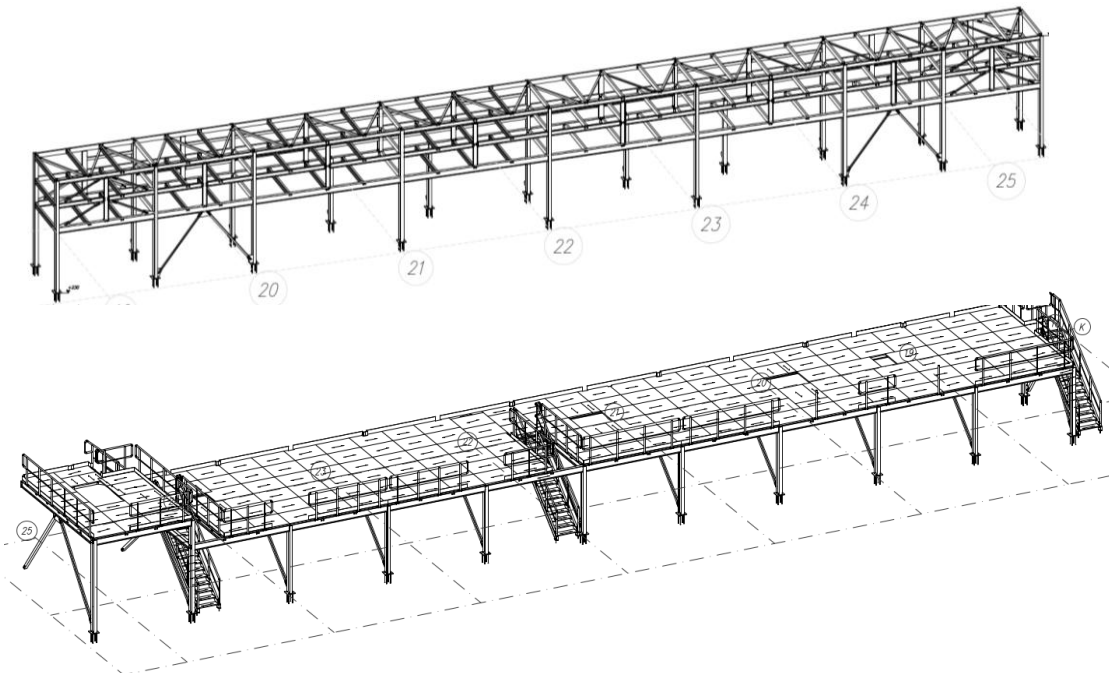


PHOTO FROM THE REALIZATION  
(ZERO MISTAKES DURING  
MANUFACTURING AND ASSEMBLY)

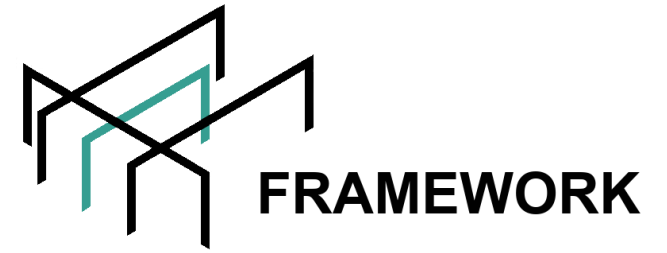


# OUR DESIGN REALIZATIONS

**CUSTOMER:** METALLURGY INDUSTRY - PGM  
**LOCATION:** ZAWIERCIE, POLAND  
**PHASE PROJECT:** DETAIL DESIGN  
**MAIN MATERIAL:** STEEL HOT ROLLED PROFILE, STEEL COVER GRATING  
**TOTAL WEIGHT:** 17 350 KG – PIPE RACK  
26 100 KG – MAINTENANCE PLATFORM



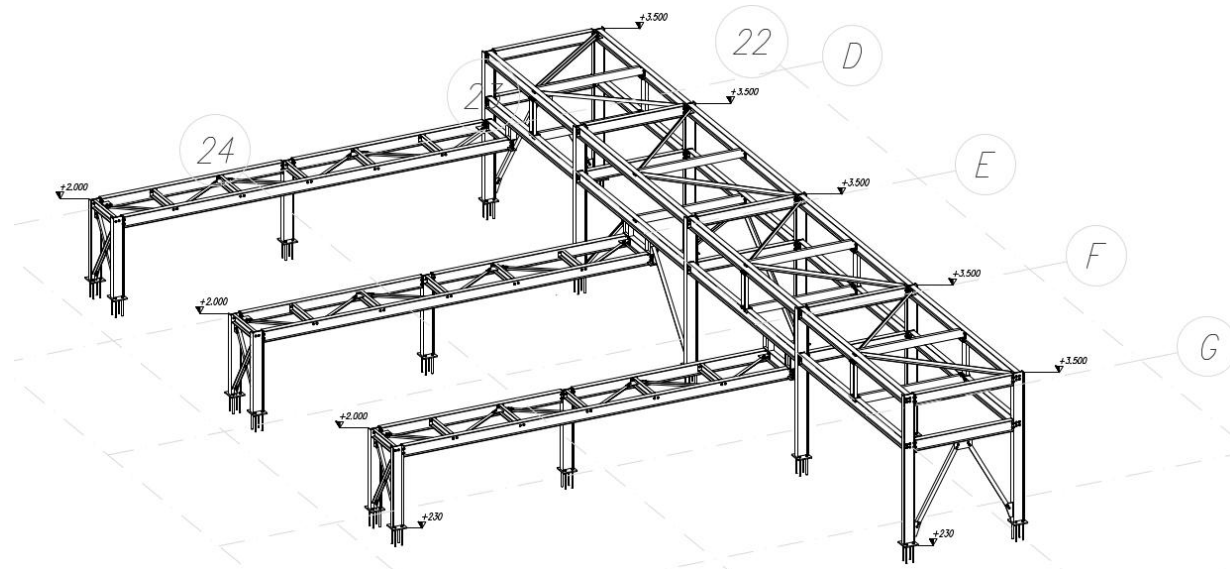
**PHOTO FROM THE REALIZATION  
(ZERO MISTAKES DURING MANUFACTURING AND ASSEMBLY)**

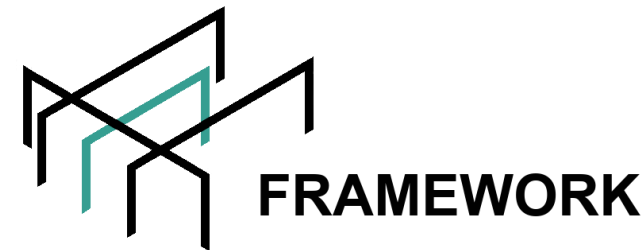


# OUR DESIGN REALIZATIONS

**CUSTOMER:** METALLURGY INDUSTRY - PGM  
**LOCATION:** ZAWIERCIE, POLAND  
**PHASE PROJECT:** DETAIL DESIGN  
**MAIN MATERIAL:** STEEL HOT ROLLED PROFILE  
**TOTAL WEIGHT:** 8 830 KG - SUPPORT STRUCTURES FOR PIPELINES

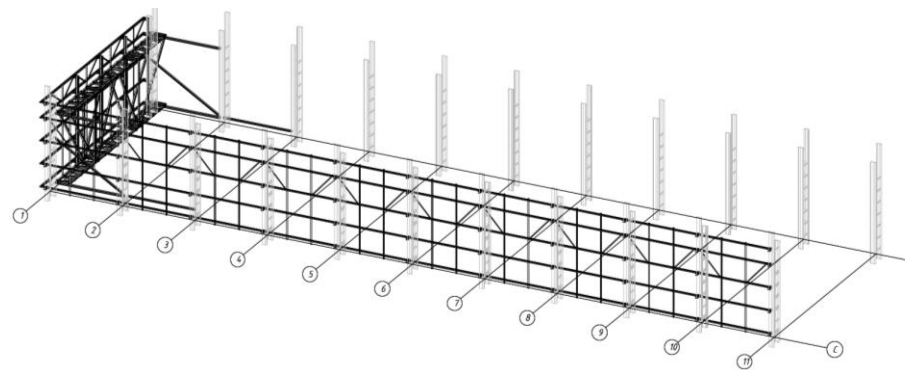
**ZERO MISTAKES DURING MANUFACTURING AND ASSEMBLY**





# OUR DESIGN REALIZATIONS

**CUSTOMER:** SMELTER PLANT  
**LOCATION:** OSTROWIEC ŚWIĘTOKRZYSKI, POLAND  
**PHASE PROJECT:** CHECKING THE EXISTING STRUCTURE AND DESIGNING A NEW PART OF THE CURTAIN WALL  
**MAIN MATERIAL:** STEEL HOT ROLLED PROFILE  
**TOTAL WEIGHT:** 16 000 KG - NEW PART OF THE CURTAIN WALL



**BASIC AND DETAIL MODEL**

**STATIC MODEL**

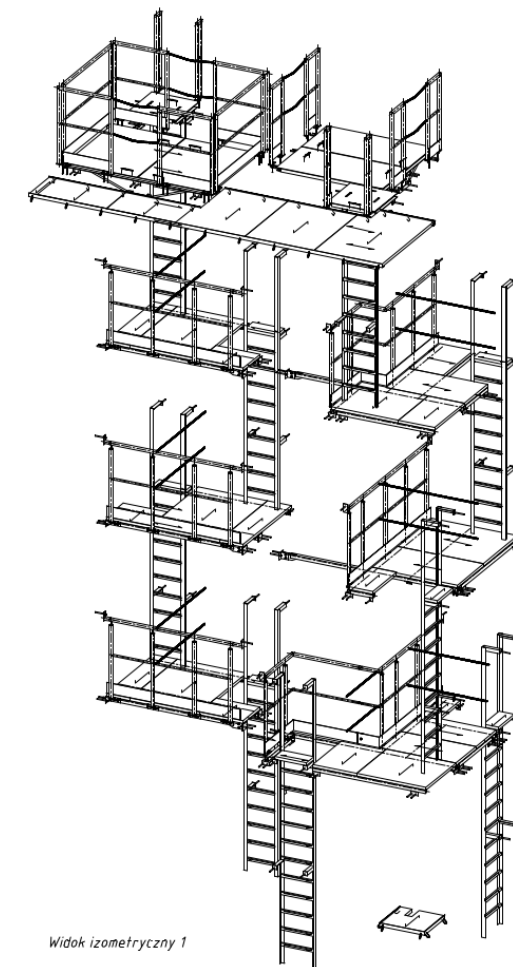
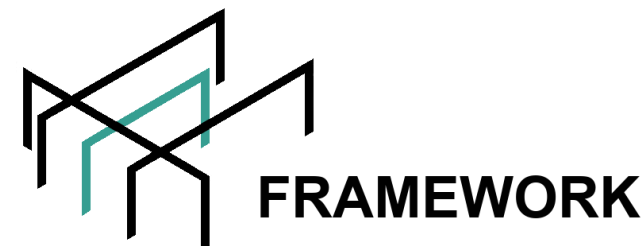


**PHOTO FROM THE REALIZATION**



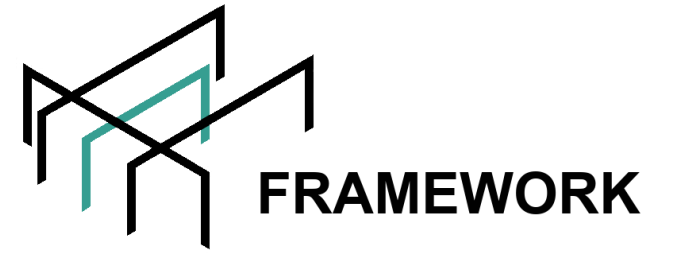
# OUR DESIGN REALIZATIONS

**CUSTOMER:** ENVIRONMENTAL PROTECTION INDUSTRY  
**LOCATION:** POLAND  
**PHASE PROJECT:** BASIC AND DETAIL DESIGN  
**MAIN MATERIAL:** STEEL HOT ROLLED PROFILE, STEEL COVER GRIDS  
**TOTAL WEIGHT:** 2 220 KG – TECHNOLOGICAL PLATFORM FOR PUMPING STATION



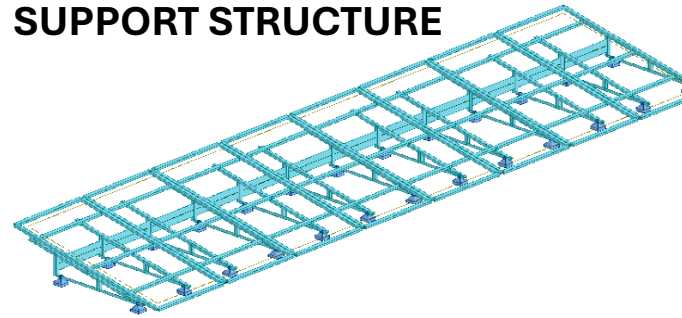


# STATIC VERIFICATION OF CONSTRUCTIONS

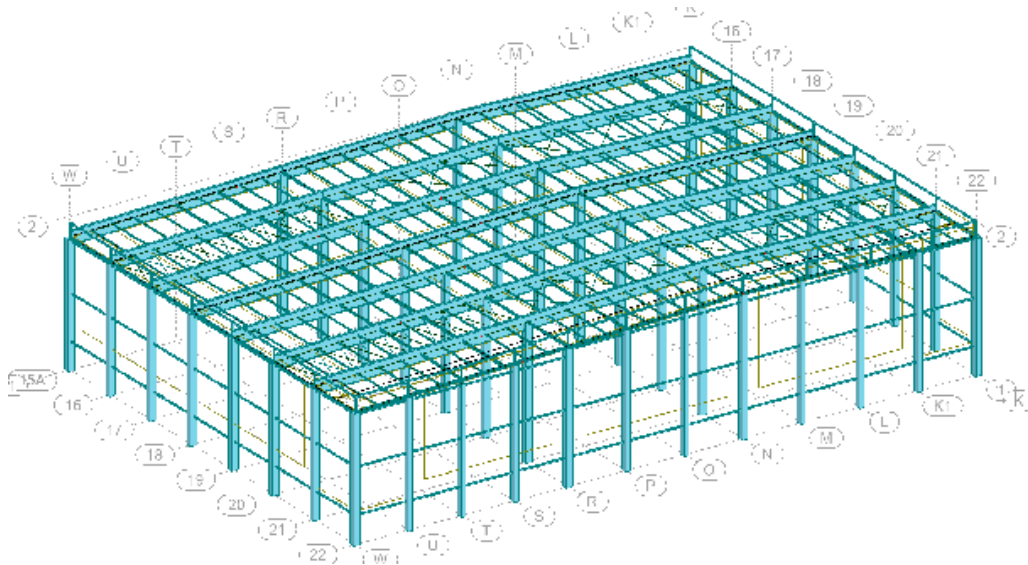


**FRAMEWORK**

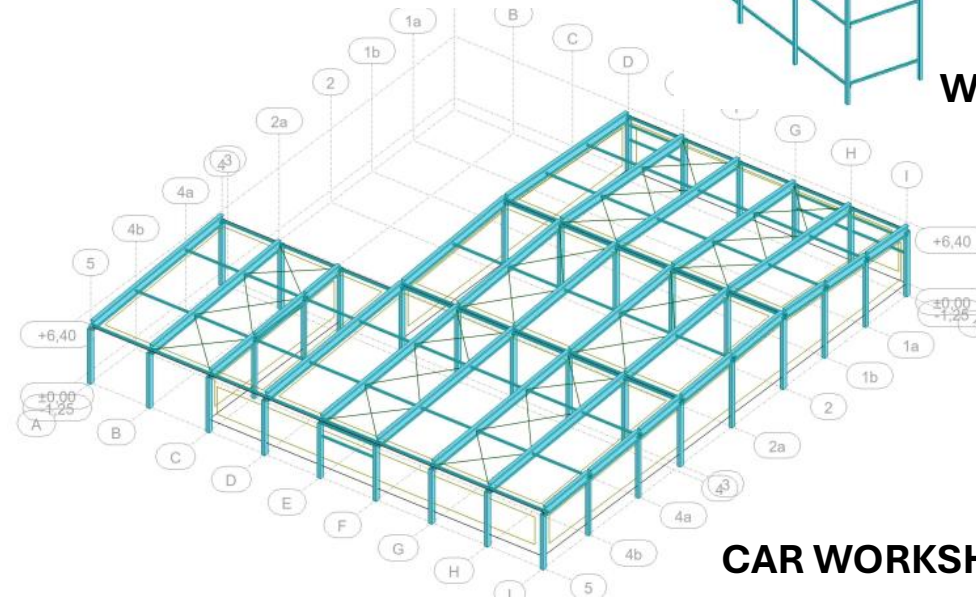
**PHOTOVOLTAICS  
SUPPORT STRUCTURE**



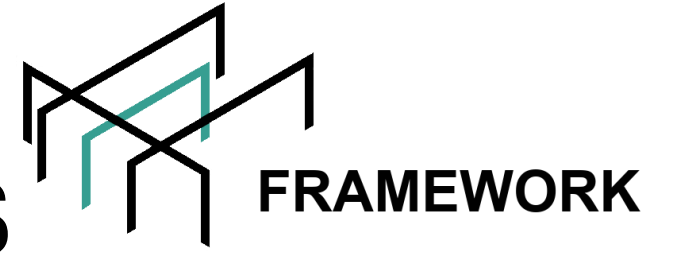
**WASTE SHELTERS**



**BUILDING EXPANSION OF MANUFACTURING PLANT  
POULTRY INDUSTRY**

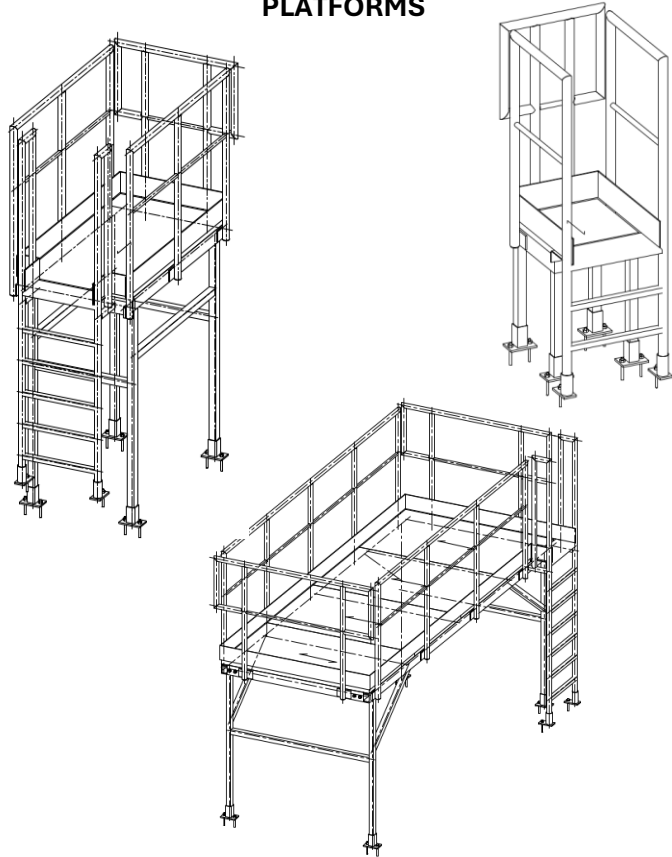


**CAR WORKSHOP**

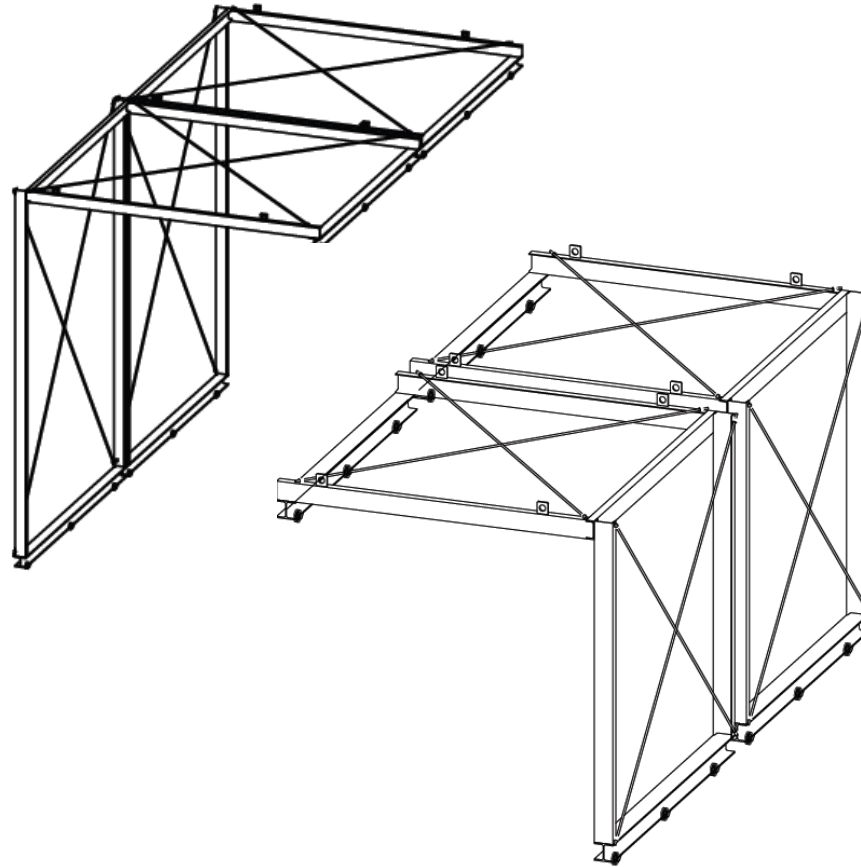


# OTHERS BASIC&DETAIL DESIGNS

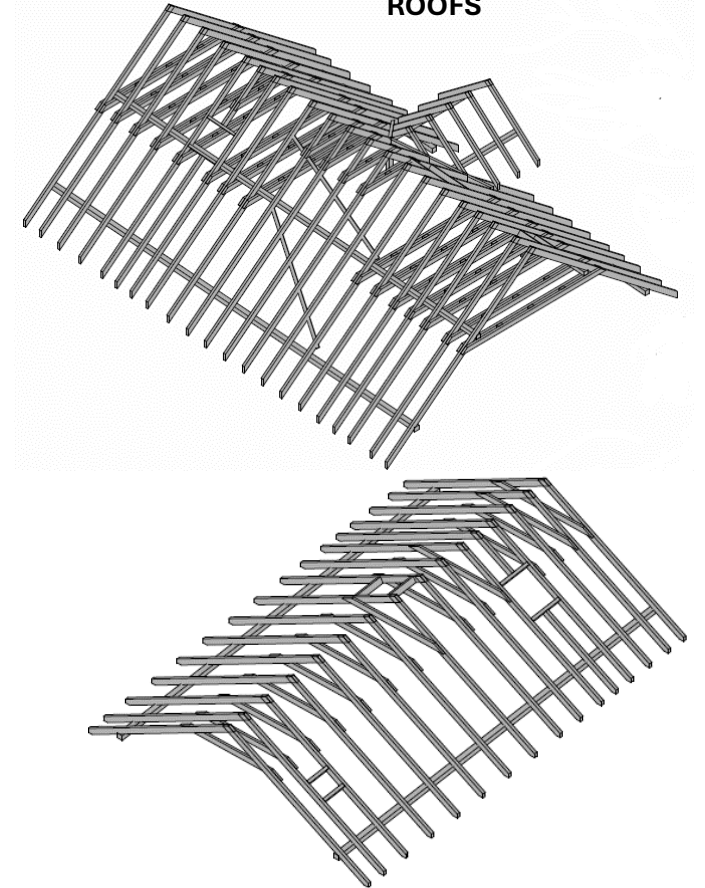
TECHNOLOGICAL  
PLATFORMS

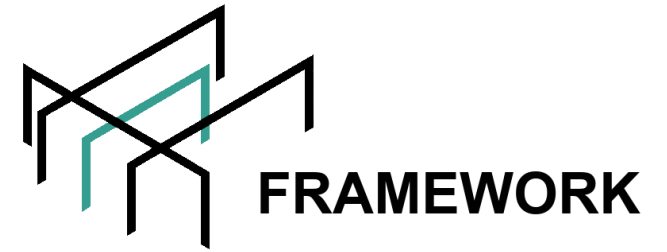


CURTAIN ACUSTIC WALLS



ROOFS



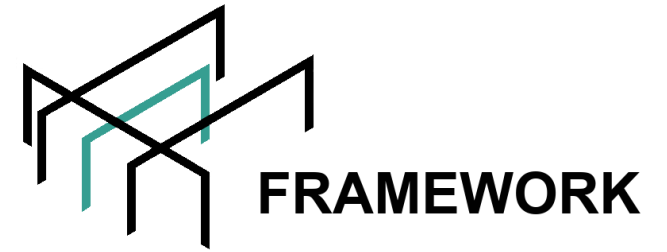


# OUR EXPERIENCE

**9 YEARS EXPERIENCE IN DESIGN STEELWORK STRUCTURE FOR AUTOMOTIVE INDUSTRY AND ANOTHER CUSTOMERS**

**4 YEARS EXPERIENCE IN DESIGN BUILDING STRUCTURES**

**PROFFESIONAL CIVIL ENGINEERING IN POLAND**  
**(POLISH CONSTRUCTION LICENSE ENTITLED TO THE DESIGN AND EXECUTION**  
**STRUCTURES REQUIRING A BUILDING PERMIT)**



# SOFTWARE

## STATIC CALCULATIONS:

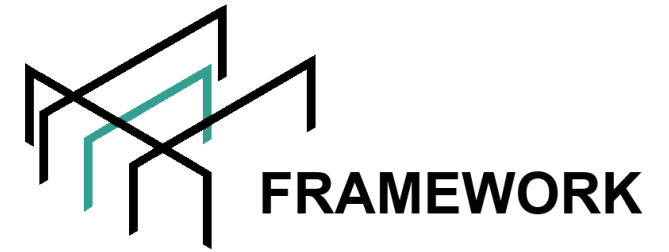
- ROBOT STRUCTURAL ANALYSIS
- IDEA STATICA

## BASIC AND DETAIL DESIGN:

- TEKLA STRUCTURES
- PROSTEEL

## BIM COORDINATION:

- NAVISWORKS MANAGE
- AUTODESK RECAP



# DESIGN CODES

## CHINESE CODES:

- GB500XX SERIES
- SEISMIC DESIGN GB50011

## US CODES:

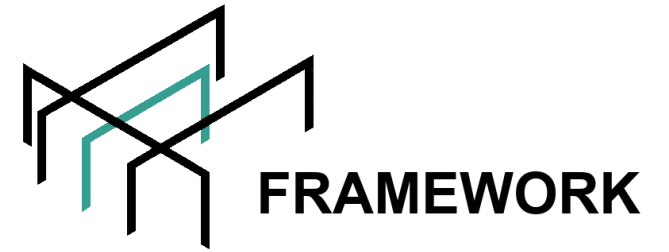
- AISC 360
- ASCE 7
- REFERENCE DESIGN GUIDE
- SEISMIC DESIGN ASCE 7 UNDER CONSIDERATION OF ASCE 341 AND OTHER

## EU CODE:

- EUROCODES 1990...1999
- SEISMIC DESIGN EC8

## BS CODE:

- BS EN 1993
- SEISMIC BS EN 1998 – EC8



**ADDRESS:**

**UL. SPORTOWA 4A / 9  
05-600 GRÓJEC, POLAND**

**TAX IDENTIFICATION NUMBER:**

**797 20 80 355**

**WEBSITE:**

**[WWW.FRAMEWORK.COM.PL](http://WWW.FRAMEWORK.COM.PL)**

**REQUEST FOR PROPOSAL:**

**HONORATA WIECZOREK - INDUSTRY SECTOR**



**+ 48 537 970 499**



**HWIECZOREK@FRAMEWORK.COM.PL**

**PAWEŁ WIECZOREK - COMMERCIAL SECTOR**



**+ 48 576 210 663**



**PWIECZOREK@FRAMEWORK.COM.PL**